

Sold

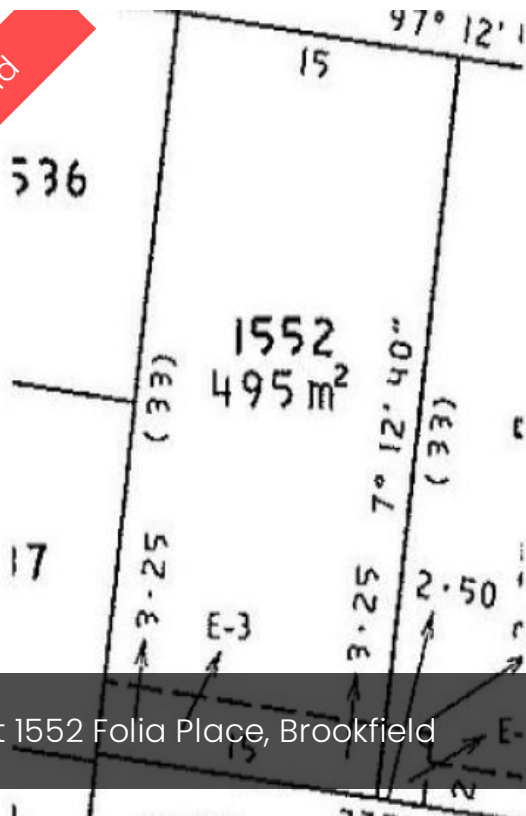

Lot 1552

495m²

15m Frontage

Lot 1552 Folia Place, Brookfield

Prime Building Blocks By King Homes

Now is the time to secure your future in this fast growing estate for Botanica Springs, having close access to the freeway, train line, and leading retail and service facilities, the lifestyle you have longed can now be a reality. Building design guidelines and developers landscaping provisions ensure high quality streetscapes. Due to have titles released in Feb 2011 you can buy now and take your time to build your dream home. There is no time to waste as these blocks are selling fast.

Exclusive To King Homes Clients Only. Choice Of Floorplans & Facades.

The above information provided has been furnished to us by the vendor/s. We have not verified whether or not that information is accurate and do not have any belief in one way or the other in its accuracy. We do not accept any responsibility to any person for its accuracy and do no more than pass it on. All interested parties should make and rely upon their own inquiries in order to determine whether or not this information is in fact accurate.

495 m²

Price	SOLD
Property Type	Residential
Property ID	627
Land Area	495 m ²

Agent Details

Ross Cooper – 0409 325 411

Office Details

Commercial
24A Kanowna St
Williamstown, VIC, 3016
Australia
03 9397 8900

